

INSTALLATION NOTES:

IT IS RECOMMENDED TO PRE DRILL HOLES WHEN ATTACHING THE TRIM AS TO AVOID SPLITTING ANY OF THE MOLDING. USE FINISH NAILS & GLUE. (RENTING A BRAD GUN IS A GOOD IDEA AND YOU WON'T NEED TO PRE-DRILL HOLES.)

TOTAL STACK HEIGHT: 6-5/16"

INSTALL WALL TO WALL:

1. INSTALL TSTM ON TOP OF CABINET. PULL FORWARD UNTIL YOU HAVE 1 1/4" OF TSTM STICKING OUT PAST FACE FRAME.
2. INSTALL CLEAT 1 1/4" IN ON TOP OF TSTM.
3. INSTALL TF396 TO CLEAT (CUT TO SIZE.)
4. INSTALL CROWN MOLDING (SWVCRM8) (CUT TO SIZE.)
5. INSTALL (ACAM) ONTO TF396 UNDER SWVCRM8 (CUT TO SIZE.)

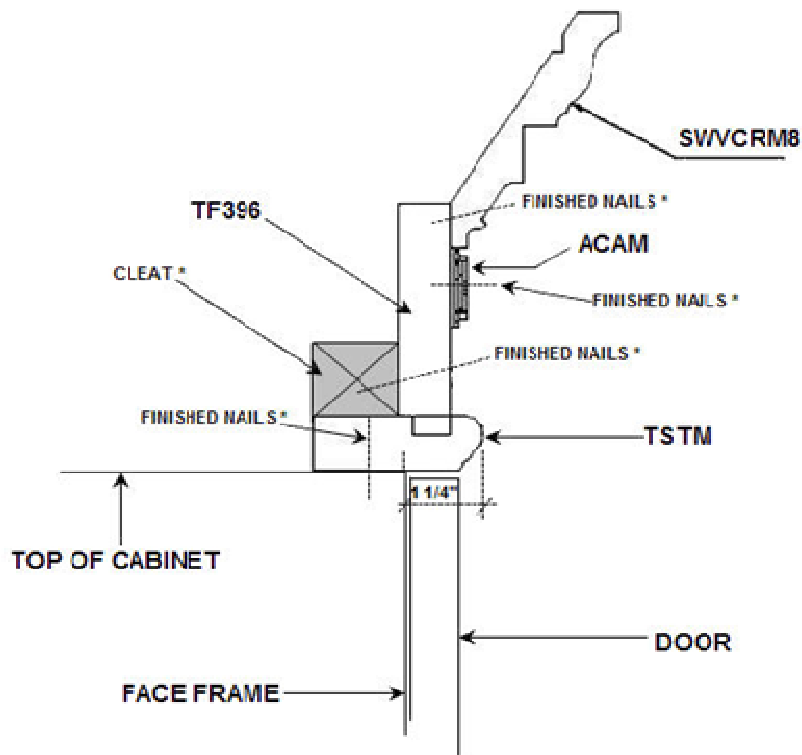

* SUPPLIED BY OTHERS.