

INSTALLATION NOTES:

IT IS RECOMMENDED TO PRE DRILL HOLES WHEN ATTACHING THE TRIM AS TO AVOID SPLITTING ANY OF THE MOLDING. USE FINISH NAILS & GLUE. (RENTING A BRAD GUN IS A GOOD IDEA AND YOU WON'T NEED TO PRE-DRILL HOLES.)

TOTAL STACK HEIGHT: 3-1/16"

INSTALL WALL TO WALL:

1. INSTALL VFR8 TO TOP OF CABINET (CUT TO SIZE.)
2. APPLY CROWN MOLDING (VCRM8) ON TOP OF VFR8 (CUT TO SIZE.)
3. ATTACH (RPM8) TO VCRM8 (CUT TO SIZE.)

NOTE! CLEAT IS OPTIONAL

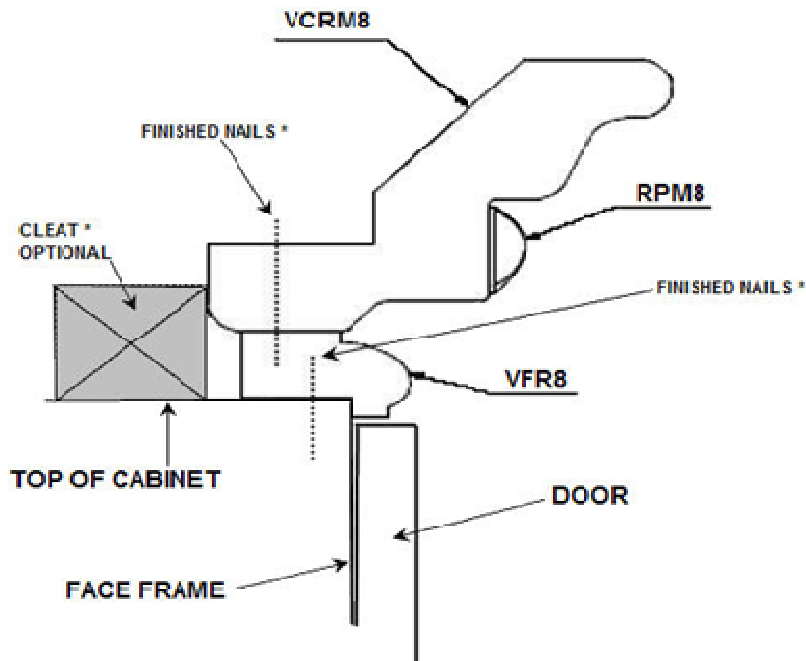

* SUPPLIED BY OTHERS.