

INSTALLATION NOTES:

IT IS RECOMMENDED TO PRE DRILL HOLES WHEN ATTACHING THE TRIM AS TO AVOID SPLITTING ANY OF THE MOLDING. USE FINISH NAILS & GLUE. (RENTING A BRAD GUN IS A GOOD IDEA AND YOU WON'T NEED TO PRE-DRILL HOLES.)

TOTAL STACK HEIGHT: FIG 1 = 6-1/8" , FIG 2 = 5-9/16"

INSTALL WALL TO WALL FIG: 1

1. GLUE & NAIL (TBP8 TO TOP OF CABINETS (CUT TO SIZE.))
2. INSTALL CLEAT #1 - 1" BACK FROM TBP8. (CUT TO SIZE.)
3. INSTALL TF396 (CUT TO SIZE.)
4. INSTALL CLEAT #2 & #3 (CUT TO SIZE)
5. ATTACH SWCRM8 TO CLEAT #3 (CUT TO SIZE)
6. ALIGN TBP8 ON TOP WITH CLEAT #2 & SWCRM8 AND ATTACH (CUT TO SIZE.)
7. NOW ADD ICM8 TO TOP OF TF396 (CUT TO SIZE.)

INSTALL WALL TO WALL FIG: 2

1. GLUE & NAIL (TBP8 TO TOP OF CABINETS (CUT TO SIZE.))
2. INSTALL CLEAT #1 – 1 3/4" BACK FROM TBP8 (CUT TO SIZE.)
3. NOW INSTALL CLEAT #2. USE 3/4" STOCK (CUT TO SIZE.)
4. INSTALL TF396 (CUT TO SIZE.)
5. ATTACH SWCRM8 TO TF396 (CUT TO SIZE).
6. ALIGN TBP8 ON TOP WITH CLEAT #2 & SWCRM8 AND ATTACH AS SHOWN (CUT TO SIZE.)
7. NOW ADD ICM8 UNDER SWCRM8 (CUT TO SIZE.)

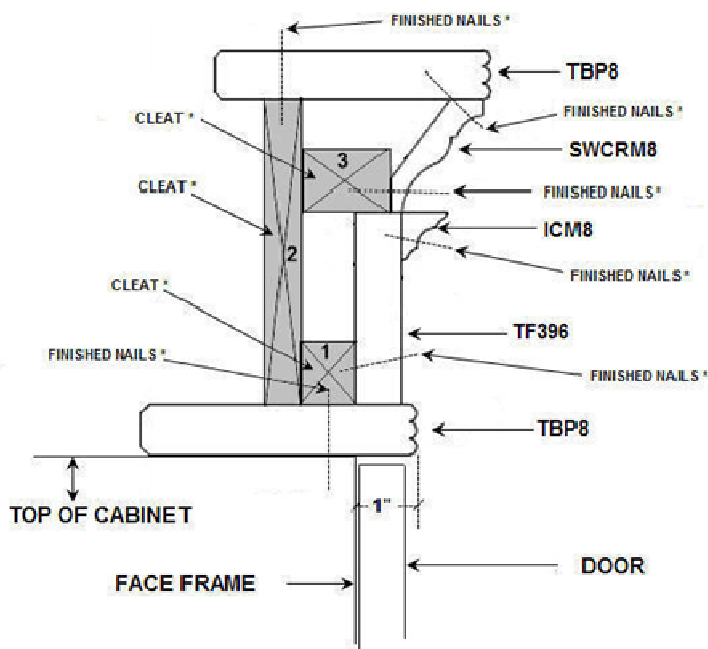

* SUPPLIED BY OTHERS.

FIG 1

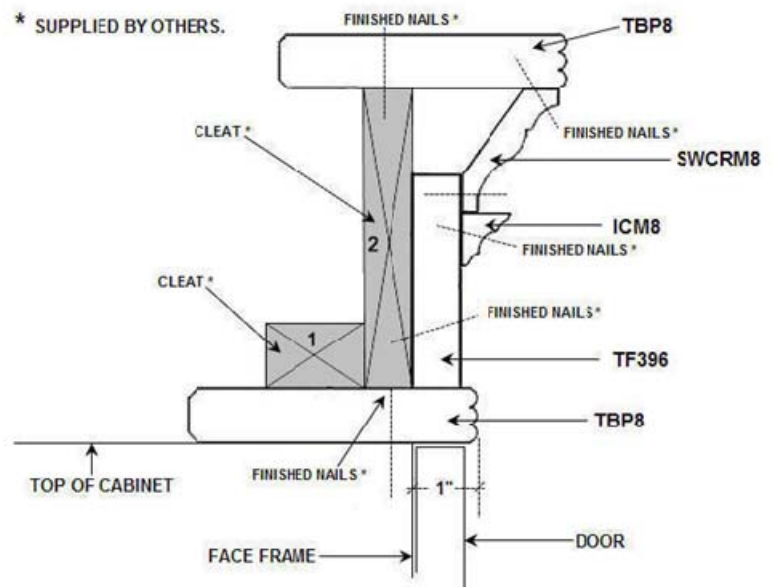

NOTE! USE THIS TEMPLATE, IF YOU WANT TO HAVE A SHORTER STACK MOLDING. (5 9/16" HIGH) AND USE LESS CLEATS.

FIG 2