

INSTALLATION NOTES:

IT IS RECOMMENDED TO PRE DRILL HOLES WHEN ATTACHING THE TRIM AS TO AVOID SPLITTING ANY OF THE MOLDING. USE FINISH NAILS & GLUE. (RENTING A BRAD GUN IS A GOOD IDEA AND YOU WON'T NEED TO PRE-DRILL HOLES.)

TOTAL STACK HEIGHT: 9-1/16"

INSTALL WALL TO WALL:

1. INSTALL CLEAT #1 5/8" BACK FROM FACE FRAME (CUT TO SIZE.)
2. GLUE & NAIL (TCM8) TOP OF CABINETS (CUT TO SIZE.)
3. ATTACH CLEAT #2 ON TOP OF CLEAT #1 & TCM8 (FLUSH IT OUT WITH FACE FRAME (CUT TO SIZE.)
4. ATTACH TF696 TO CLEAT #2 (CUT TO SIZE.)
5. ATTACH CROWN MOLDING (SWVCRM8) ON TOP OF T696 5" UP FROM THE TOP OF TCM8.

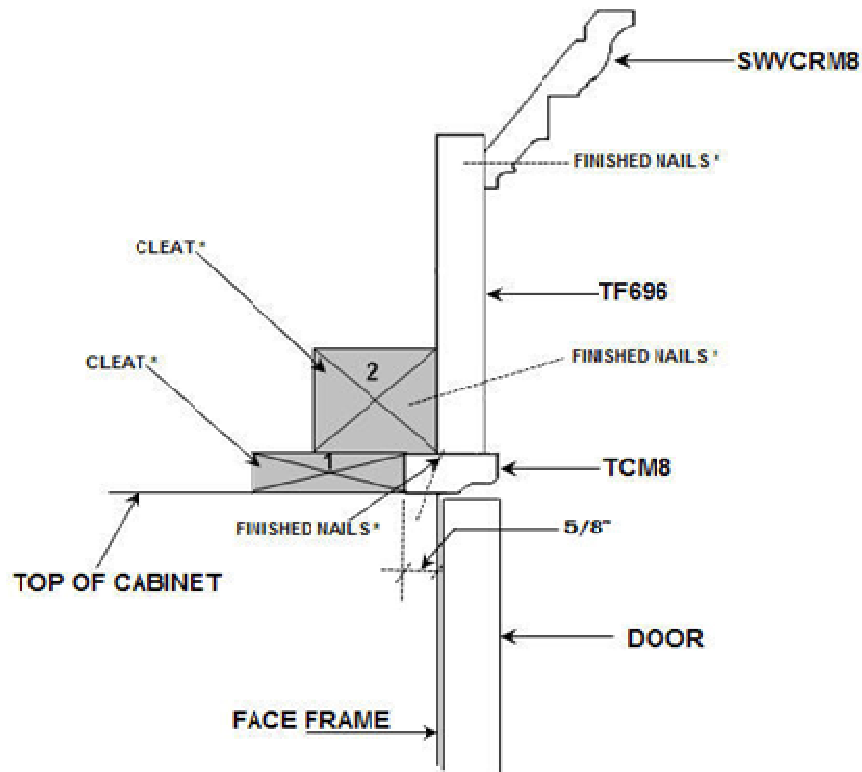

* SUPPLIED BY OTHERS.